

X200S CAMERA GLASSES User Manual

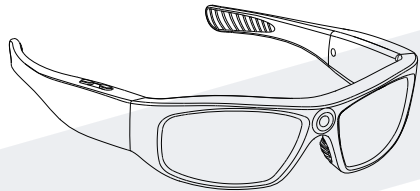

Diagram

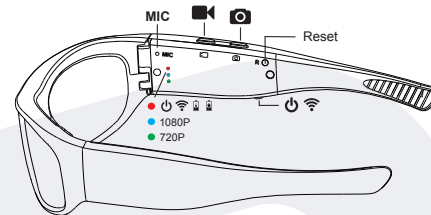
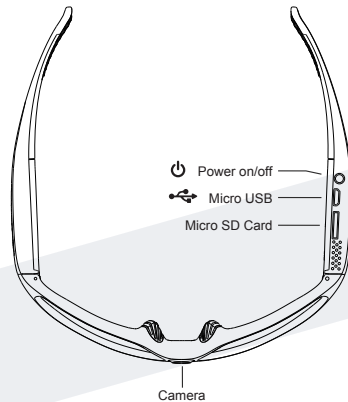

1

photo. Blue or Green light flash 1 time indicating 1 photo is taken. When capturing the photo in 1080P mode, you will get the photo with 1920x1080 pixels. When capturing the photo in 720P mode, you will get the photo with 1280x720 pixels.

Download and Play

Connect the glasses to your computer. The Removable Disk appears in Windows Explore. Open the **HD VIDEO** folder in the Glasses memory, play the videos with "Windows Media Player" or other supported media player.

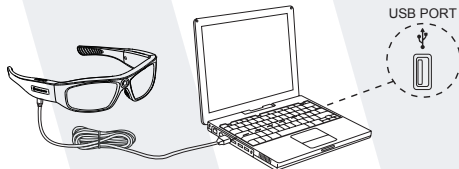

Although the glasses record in HD resolution, the video quality is limited to your computer's resolution. To see your recording in HD you should play the video on a HD compatible device. For optimal performance save video and photos to your computer before viewing.

Note: If the computer USB port has insufficient power supply it may cause USB connection failure. Please try again with another USB port or connect the glasses to a different computer.

PC / Web Camera

The PC / Web camera is free of driver installation. Connect the glasses to your computer. The Removable Disk appears in Windows Explorer. Copy the PC camera software

4

onto the desktop of your computer. Hold **■** down for 3 seconds, the Removable Disk disappears from Windows Explorer and the lights show solid blue & green indicating the PC / Web camera mode is ready. (Red light indicates the status of battery charging.) Run the "PC Camera.exe" software on your desktop to access the PC camera feature of the glasses. You can also use the camera for the online video chatting.

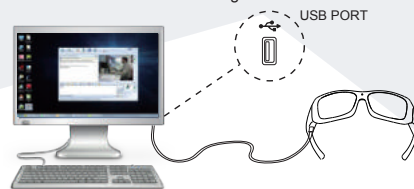

To return the Removable Disk mode, reset the glasses recorder or reconnect the USB cable to your computer.
Note: PC Camera is not workable on Mac OS.

Troubleshooting

Unable to Turn on the Glasses

Check the battery power. Recharge the battery if the power is exhausted.

Unable to Take Video/Photo

Please check if the memory card is full. Delete or remove the previous video/photo files for releasing memory space of your Glasses.

Auto Shut-Off

Check the battery power. Recharge the battery if the power is exhausted. If auto shut-off on Video Recorder mode, check if the memory card is full. Delete or remove the previous video/photo files to your computer hard disk for releasing memory space of your glasses.

5

Status	Controls	Indicator/Vibration
Power On	1 tap ⏻ (enters standby after 4 sec.)	Solid red, 1 vibration
Take 1080P Video	1 tap ■ to take video at 1080P@30fps	Solid blue
Take 720P Video	Hold ■ down for 2 sec. to take video at 720P@60fps	Solid green
Stop Video Rec.	1 tap ■ (return to standby)	Solid red
Take 1 photo	1 tap 📷 (in standby mode)	Solid red, 1 flash blue & green
Continuous Shooting	Hold 📷 down for 3 sec. to take 5 continuous photos (in standby mode)	Solid red, 2 flash blue & green
Capture in Recording	1 tap 📷 during video recording	Solid red, 1 flash blue & green
Power Off	Hold ⏻ down for 3 sec.	Indicator goes off, 1 vibration
Charge	Connect to a PC or Mac USB port	Flash red
Fully Charged	(Connected with USB charger)	Solid red (Solid green)
Low Battery	(Automatically Power Off)	Indicator goes off, 1 vibration
Memory Full	(Automatically Power Off)	Indicator goes off, 1 vibration
Removable Disk	Connect to a running PC or Mac	Indicate charging status
PC Camera	Hold ■ down for 3 sec. in Removable Disk mode	Solid blue & green, red light indicates charging status
Reset	Press Reset Button	Indicator goes off

Charge

Use the included USB cable to connect the glasses to a running computer or Mac. A blink red light indicating the battery is charging. **Allow to charge for a minimum of 3 hours.** (Until the indicator turns solid red)

2

Removable Disk is Not Found in Windows or Mac

Check if the USB connection is fine. If the red light didn't turn on, you have not connected the glasses to your computer. Try to connect the glasses to another USB port or connect the glasses to a different computer or Mac.

Resetting

Most problems can be solved by resetting. Simply reset the glasses by press **RESET** button.

- Resetting will not erase the photos, videos and other files stored in the glasses memory card.
- If the reset procedure does not work, charge the battery and try again.

Technique Data

Camera	8.0M Pixels Color CMOS
View Angle	75°
Video Format	H.264 (1080P@30fps, 720P@60fps)
Photo Format	JPEG
Memory Type	Micro SD Card (Class 10 and up Max 32GB)
Battery Type	Built-in 620mAh 3.7 Li-ion Polymer Battery
Input Power Rating	DC 5V 500mAh
Charging Time	3 hours for full charging by computer USB
Battery Duration	1 hour video recording after fully charged
Interface	USB2.0
Operation System	Windows XP / 7 / 8 / Mac OS / iOS / Android
Operating Temperature	32-104°F (0-40°C)
Storage Temperature	32-104°F (0-40°C)
Operation Humidity	15-85%RH

6



Take a Video

Turn on your glasses recorder by 1 tap **⏻**, indicator shows solid red indicating the glasses recorder is on standby mode. 1 tap **■** to take video in 1080P@30fps, indicator turns solid blue. 1 tap **■** again to stop recording and return to standby mode, indicator shows solid red. Hold **■** down for 3 seconds to take video in 720P@60fps, indicator shows solid green. 1 tap **■** again to stop recording and return to standby mode, indicator shows solid red. Hold **⏻** down for 3 seconds to save the recording file and turn off the glasses recorder. Indicator goes off with 1 vibration indicating the glasses recorder is turned off.

Take a Photo

Take photos in standby mode: 1 tap **📷** to take a photo, indicator shows 1 flash blue & green. Hold **📷** down for 3 seconds to take 5 continuous photos, indicator shows 2 flashes blue & green.

Take photos in video recording status: 1 tap **📷** to capture a

3

Weight & Dimension	55g / W161 x D164 x H45 (mm)
Lens	Polarized lens, UV400 Protection
Frame	Gilamid Nylon TR90

Attention

File safety: The product is not a professional storage device, therefore it does not guarantee the completeness and safety of the stored files. Please back up your important files on a computer or other storage device.

Battery: If the battery is exhausted, please recharge the battery in time. If you don't use the product for a long time, please charge the battery before storage to avoid battery over discharge.

In the box

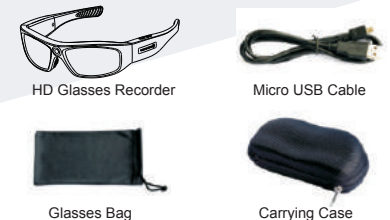

Quick Start Guide



7